

# Appendix B

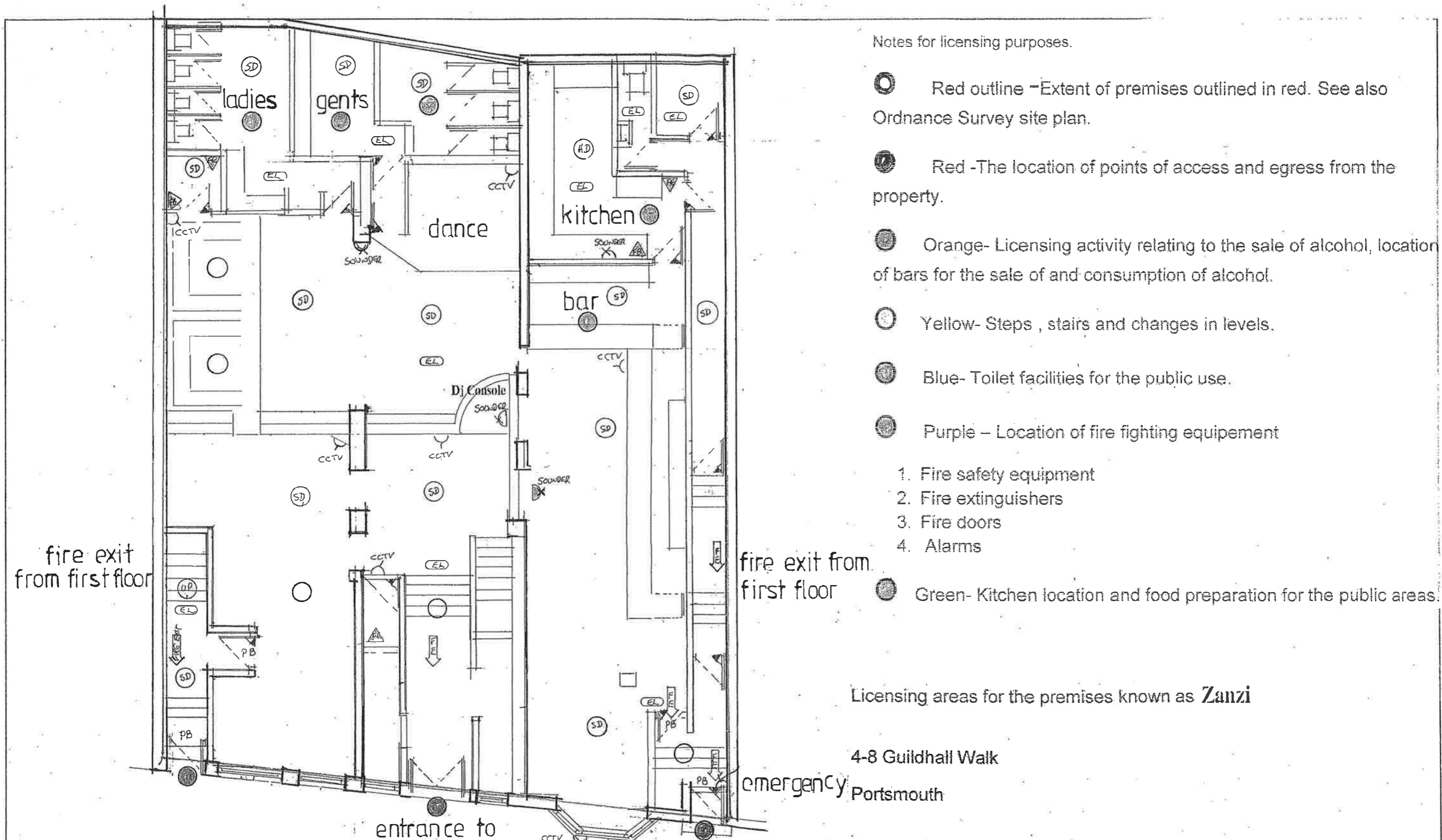

Notes for licensing purposes.

- Red outline - Extent of premises outlined in red. See also Ordnance Survey site plan.
  - Red - The location of points of access and egress from the property.
  - Orange - Licensing activity relating to the sale of alcohol, location of bars for the sale of and consumption of alcohol.
  - Yellow - Steps, stairs and changes in levels.
  - Blue - Toilet facilities for the public use.
  - Purple - Location of fire fighting equipment
1. Fire safety equipment
  2. Fire extinguishers
  3. Fire doors
  4. Alarms
- Green - Kitchen location and food preparation for the public areas.

Licensing areas for the premises known as **Zanzi**

4-8 Guildhall Walk

emergency: Portsmouth

fire exit from first floor

fire exit from first floor

entrance to ZANZI

- cctv
- emergency light
- smoke detector
- illuminated fire exit
- sounder
- fire extinguisher
- water
- fire blanket

## Ground Floor Plan

Scale 1:100

project			
title		drawing no.	
revision suffix			
SURVEY	DESIGN	WORKING DRAWING	
FEASIBILITY	TENDER	AS-BUILT	
Rev	REVISION DETAILS	Amended by	Approved by
		date	scale